

# Tinting: Using the Transparency Brush

DIP 9, 10, 2006

©kimlizzy 2006

email: [kimlizzy@iinet.net.au](mailto:kimlizzy@iinet.net.au)

Open your picture.

Duplicate: Edit/Duplicate whole project

Close the original.

Duplicate the copy: Ctrl + d

Keeping the top layer active, go to Effects/Black and white



Still working on the top layer: Go to Effects/Transparency/Transparency Brush

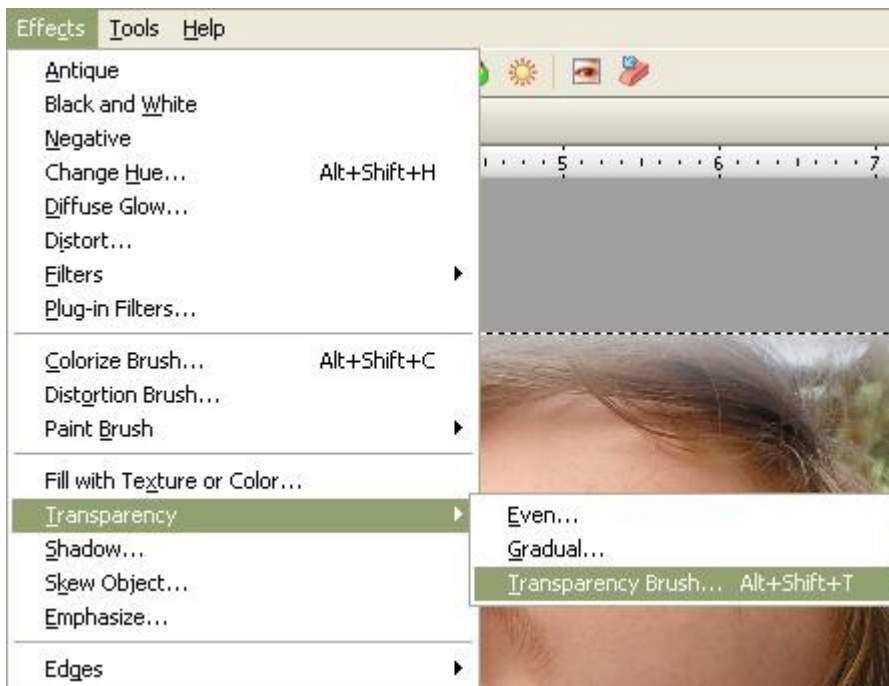

Select a suitable brush size.

Choose either a soft or hard edge. (I chose Hard.)

Make sure you move the transparency slider to 100%.

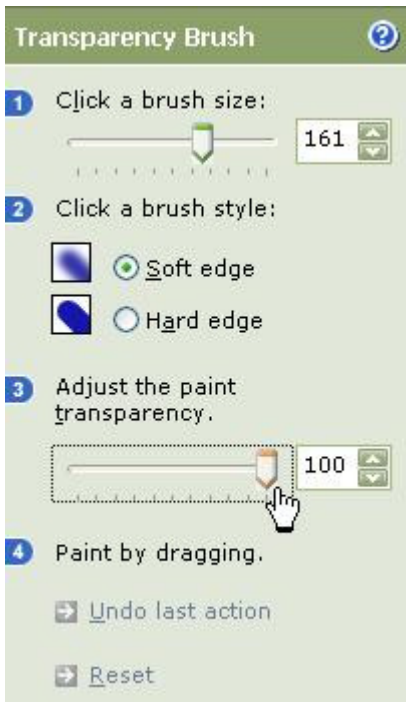

“Paint” over the parts you want coloured. Reduce the brush size when necessary. A smaller brush is best for the edges. You are actually “erasing” part of the B&W photo to reveal the coloured photo underneath.



\*\*\* TIP: If you “paint” too much at a time without releasing the mouse button and you make a mistake you will have to start over. Release the mouse button intermittently. If you make a mistake you can “undo” a couple of steps at a time. Click on Done when finished.



Flatten the layers and save as jpg